

# Streamline Sit Stand Desk

## PARTS DIAGRAM



Scan for Assembly Video

### INDEPENDENT TABLE

For tables up to 60"

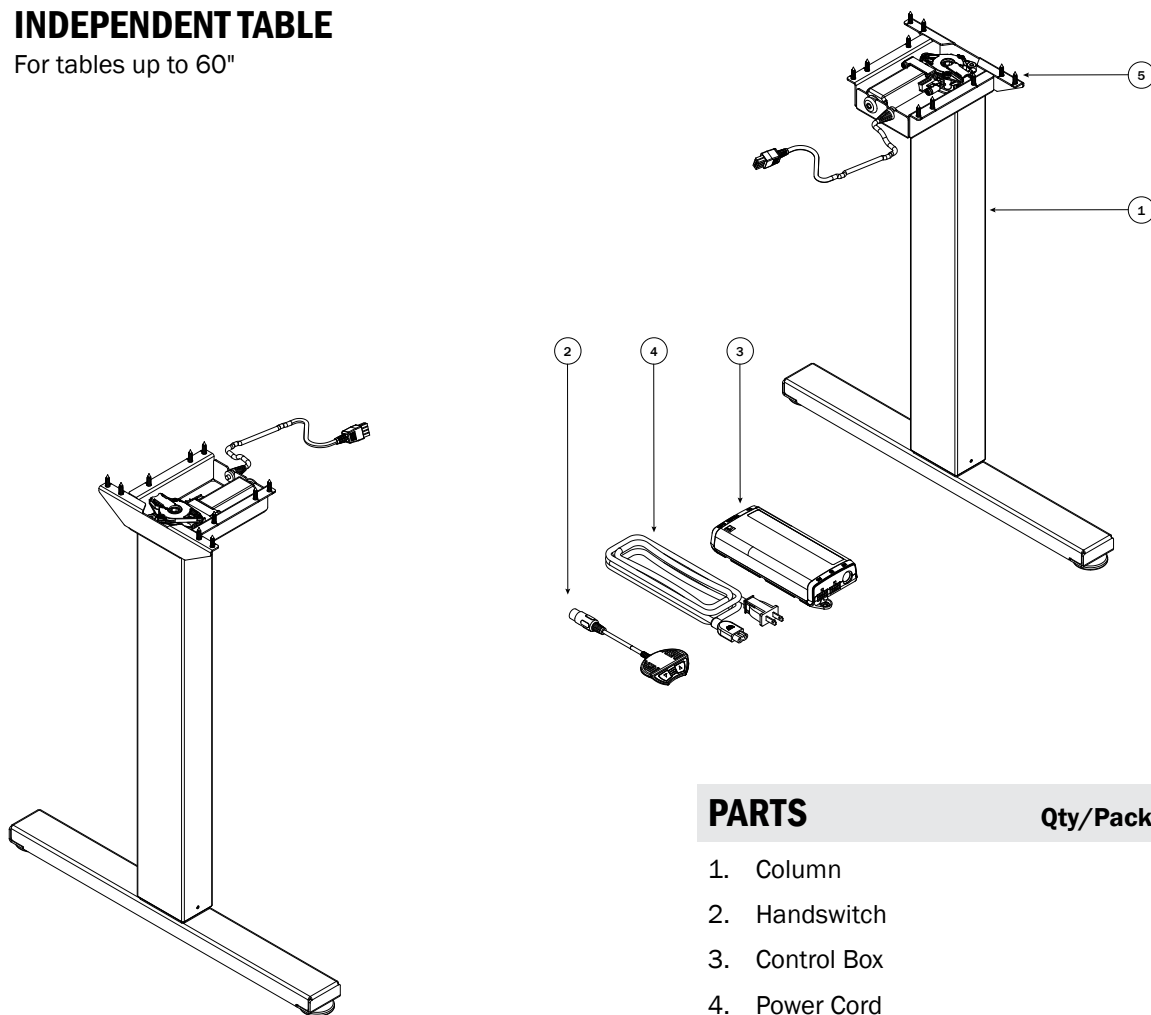

#### PARTS

Qty/Package

1.	Column	2
2.	Handswitch	1
3.	Control Box	1
4.	Power Cord	1
5.	#10 x 3/4" Screw	24



# ASSEMBLY INSTRUCTIONS

The assembly of the table frame to be made in accordance with this manual. Changes to the table frame or improper use may affect the safety, function, and life of your product.

*This manual is for all sit-stand tables from the OV1020 series.*

## ASSEMBLY OVERVIEW

1. Assemble the columns to the top
2. Fasten the control box and handswitch to the table top
3. Connect the motor cables to the control box
4. Connect the handswitch (HS) cable to the control box
5. Connect the supplied power cord (AC) to the control box
6. Attach all cables to the table frame or on the underside of the table top

If you have any difficulty assembling this unit, or need to order replacement parts, please contact our Customer Service department. Use the parts diagrams on page 4-5 as a reference.

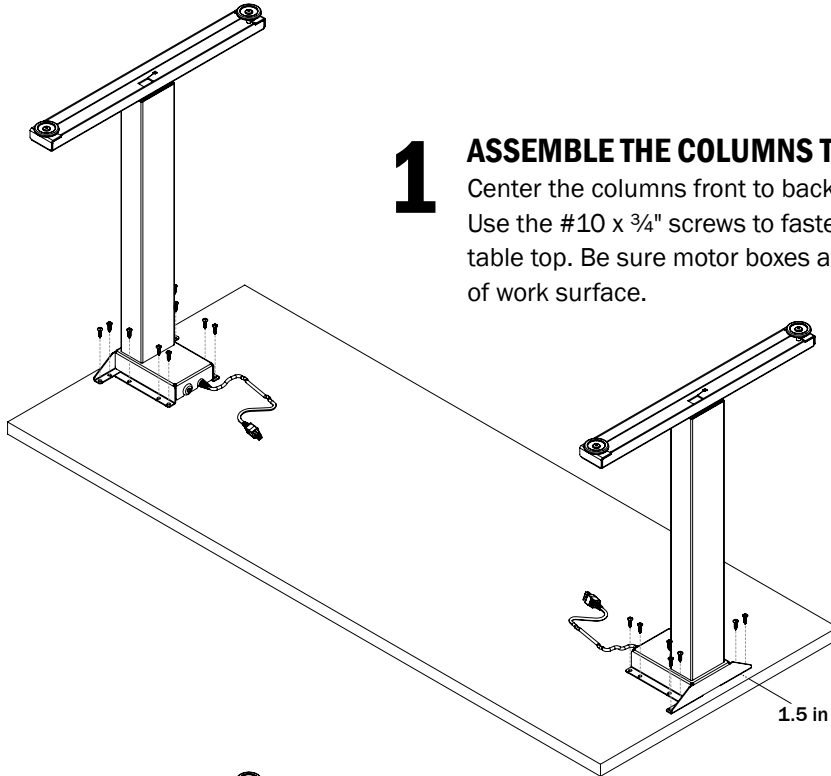

**1 ASSEMBLE THE COLUMNS TO THE WORK SURFACE**

Center the columns front to back on the work surface. Use the #10 x 3/4" screws to fasten the top support onto the table top. Be sure motor boxes are mounted 1.5" from edge of work surface.

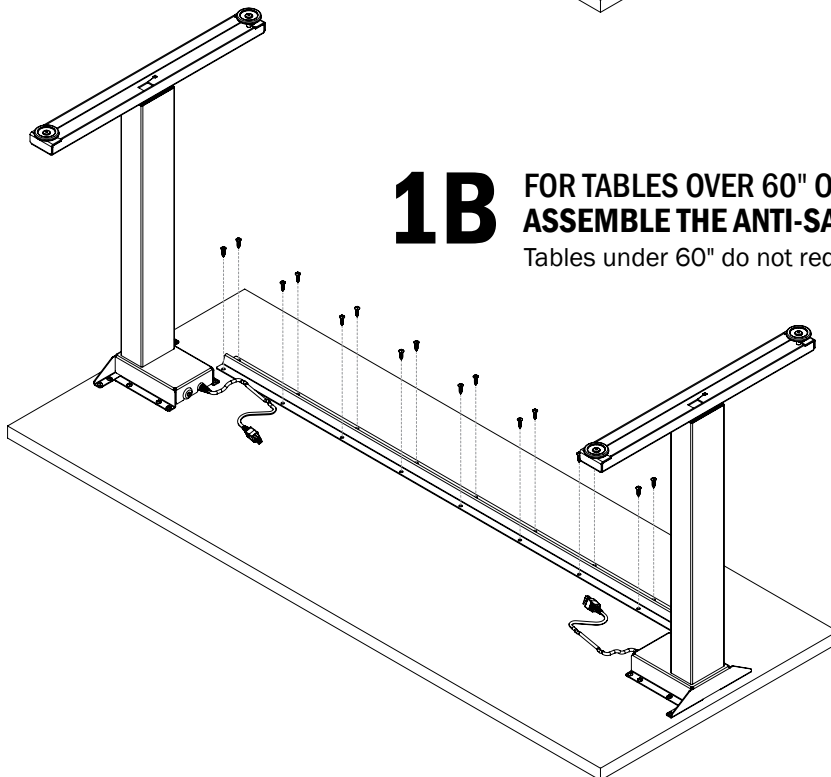

**1B FOR TABLES OVER 60" ONLY ASSEMBLE THE ANTI-SAG BAR TO THE WORK SURFACE**

Tables under 60" do not require anti-sag bar.

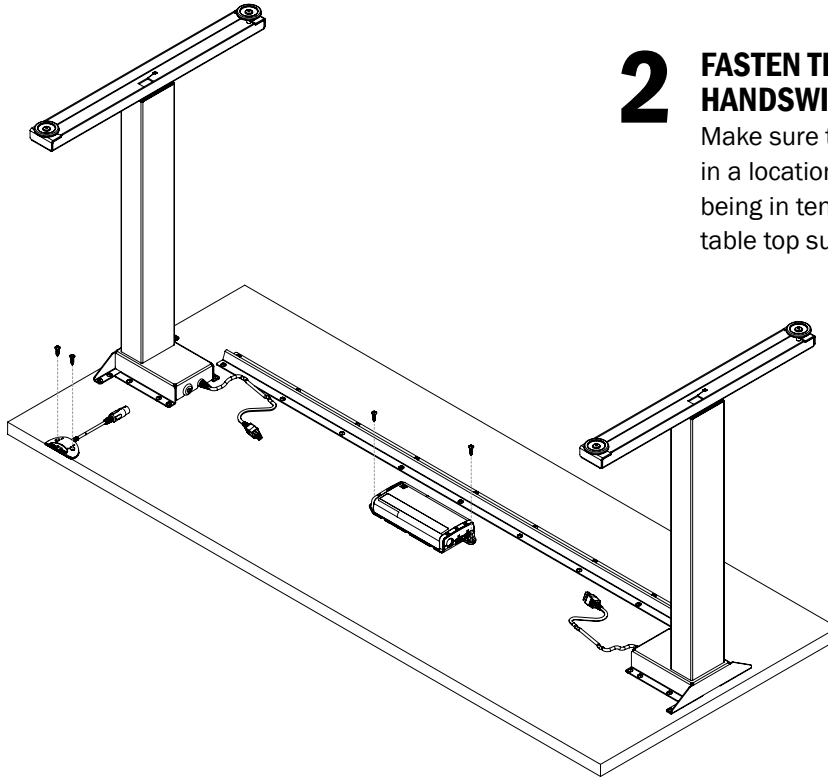

## 2 FASTEN THE CONTROL BOX AND HANDSWITCH TO THE TABLE TOP

Make sure the control box and handswitch are fastened in a location where all the cables will connect without being in tension. Be sure to use approved screws per the table top supplier.

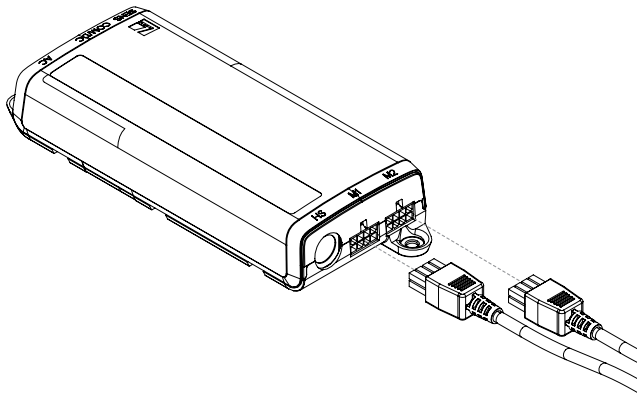

## 3 CONNECT THE MOTOR CABLES TO THE CONTROL BOX

The motor cable plug-connection has to click into place.

Connections to the control box:  
M1-M2 = Connectors for the columns  
HS = Connectors for the handset  
AC = Connector for the power cord (3-pin)

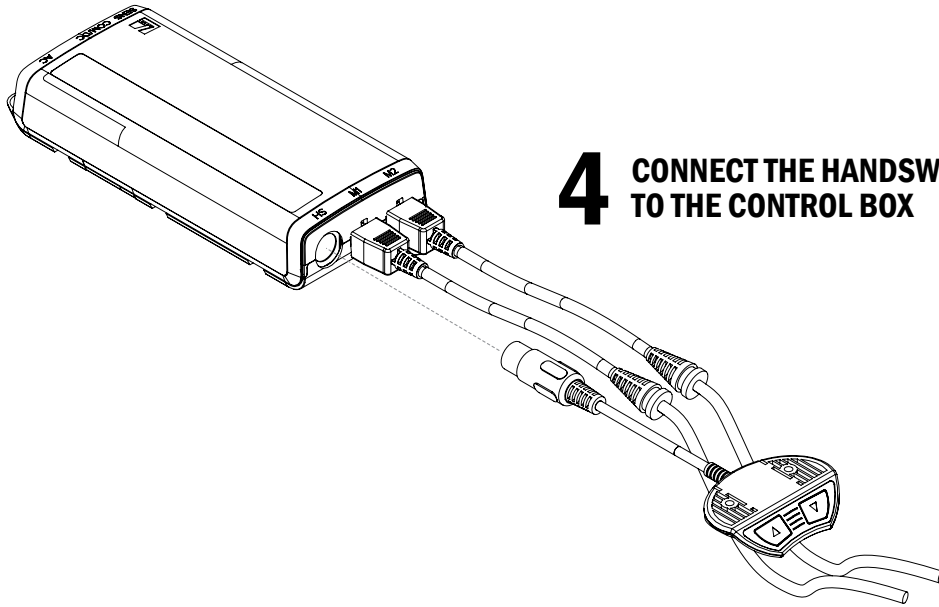

**4** CONNECT THE HANDSWITCH (HS) CABLE TO THE CONTROL BOX

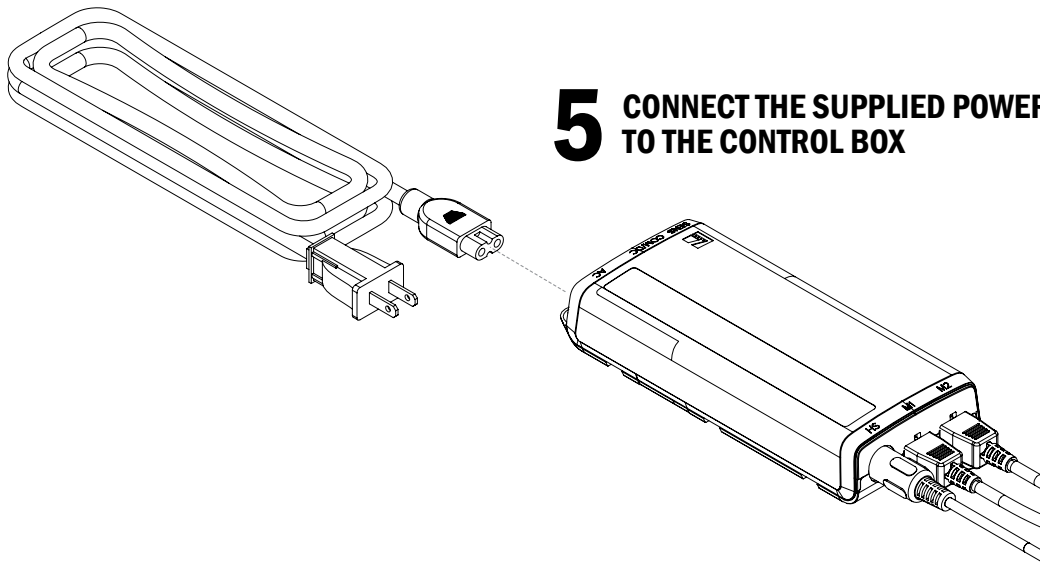

**5** CONNECT THE SUPPLIED POWER CORD (AC) TO THE CONTROL BOX

**6** ATTACH ALL CABLES TO THE TABLE FRAME OR ON THE UNDERSIDE OF THE TABLE TOP

Attach cables in order to avoid any damage during operation.  
Never wrap cables and/or cords around the columns.

# OPERATION INFORMATION

## INITIALIZATION/RESET

The desk must be initialized/reset after any of the following:

- After assembly
- After disconnection from the power supply
- After any impact on the table top.

To initialize/reset, move the table to the lowest position by pressing the DOWN button on the handswitch until the columns reach the lowest position. Press the DOWN button again until the table moves slightly back up to the operation zero point. Release the DOWN button. If the button is released too soon, the table legs will not move up. Repeat the reset process.

The control box is programmed with a parameter file which controls the table legs' lower and upper travel limits. **Under no circumstance should a control box from one table be moved to another.**

## NORMAL HANDSWITCH OPERATION (for all handswitch types)

By pressing the UP or DOWN buttons, the table will move up or down to the desired position. Once the desired position is reached, let go of the UP or DOWN button. The table legs will stop once they reach the lower or upper height limits.